

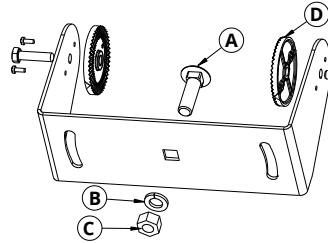

PRE-INSTALLATION INFORMATION

- Estimated Time** 15 minutes
- Tools Needed** 3/4" Wrench (Mounting)
1/2" Wrench (Aiming)
- In the Box** (x1) Model 523 BLU Safety Spot Light
- Pre-Installed on Bracket:**
 - A. (x1) 1/2"-13 x 1.00" Mounting Bolt
 - B. (x1) 1/2" Split Lock Washer
 - C. (x1) 1/2"-13 Hex Nut
 - D. (x2) Hub Adjuster
 - E. (x2) 5/16"-18 x 1.25" Aiming Bolts
 - F. (x4) #6-19 x 3/8" Screws
- Wire Functions** Black = Ground
Red = Power
- Input Voltage** 24V DC
- Operating Voltage** 20-32V DC



Pre-Installation Guidelines

1. Read all safety notes and mounting guidelines before installing the product. Verify that all parts listed under "In the Box" are present and complete.
2. Inspect the product for damage. **DO NOT** install the product if there is any damage. Contact the authorized retailer where you purchased it to initiate a warranty claim if there is damage.
3. Verify that all power supply and/or charging systems comply to the specified voltage limits for the light.

PRODUCT WARRANTY:

If you have issues with a J.W. Speaker product, please contact the authorized retailer where you purchased it.

Installation Instructions

1. Turn off the equipment and disconnect the power supply.
2. Ensure that the mounting location is a **FLAT, SOLID** surface of the same (or larger) size as the bracket or light. This will prevent warping or distortion that can cause cracking or damage to the light and/or bracket. There should also be a minimum of 1.25mm of space around the lamp in all directions.
3. Secure the light to the mounting surface then aim the light using the hub adjuster and aiming bolts.
4. Check condition of all wires, connectors, mating connectors, and gaskets. All connections should be adequately protected against moisture. Shrink tubing is recommended.
5. Lay and secure the wiring so that no pulling or abrasion can occur. Proper installation requires there to be a little slack near the lamp to avoid pulling on the connector (which can create a path for water ingress). Wires should be adequately secured to avoid damage.
6. Carefully connect the wires using the "Wire Functions" and "Voltage" information above. Push firmly on the connector to ensure that it is properly mated with the lamp, creating a seal to protect against water ingress.

Mounting Guidelines

Mounting Height	Max Lux	Pattern Diameter
20 feet	1,410	2.50 feet
30 feet	626	3.75 feet
40 feet	352	5 feet
50 feet	226	6 feet