

INSTALLATION INSTRUCTIONS

⚠ WARNING

To properly install this warning light you should have a good understanding of automotive electrical procedures and systems, and proficiency in the installation of warning lights. **IF YOU DO NOT, PLEASE SEEK PROFESSIONAL ASSISTANCE.**

BEFORE INSTALLATION:

- Estimated Time:** 60 Minutes
- Tools Needed:** Screwdriver (varies by vehicle)
- Wire Functions:**
- Red = Front Position
 - White = High Beam
 - Yellow = Low Beam
 - Black = Ground
 - Purple = DRL
 - Orange/White = Front Turn

- In the Box:**
1. (1x) Model 8632
 2. (1x) Mounting Bracket
 3. (1x) Hex Bolt
 4. (1x) Bolt
 5. (1x) Nut
 6. (1x) Split Lock Washer
 7. (1x) Hex Nut

Input Voltage: 12-24V DC

Operating Voltage: 10-32V DC

⚠ **WARNING:** Cancer and Reproductive Harm - www.P65Warnings.ca.gov
 ⚠ **AVERTISSEMENT:** Cancer et effet nocif sur la reproduction - www.P65Warnings.ca.gov

PRE-INSTALLATION INSTRUCTIONS:

1. Read all safety notes and mounting guidelines before installing the product. Verify that all parts listed under "In the Box" are present and complete.
2. Inspect the product for damage. DO NOT install the product if there is any damage. Contact the authorized retailer where you purchased it to initiate a warranty claim if there is damage.
3. Verify that all power supply and/or charging systems comply to the specified voltage limits for the light.

NOTES:

In using this guide, you agree J.W. Speaker is not responsible for any damage, misuse, or personal injuries. This document is intended as an educational guide only and does not make guarantees on any finished results.

To properly install this light you should have a good understanding of automotive electrical procedures and systems, and proficiency in the installation of lights. **IF YOU DO NOT, PLEASE SEEK PROFESSIONAL ASSISTANCE.**

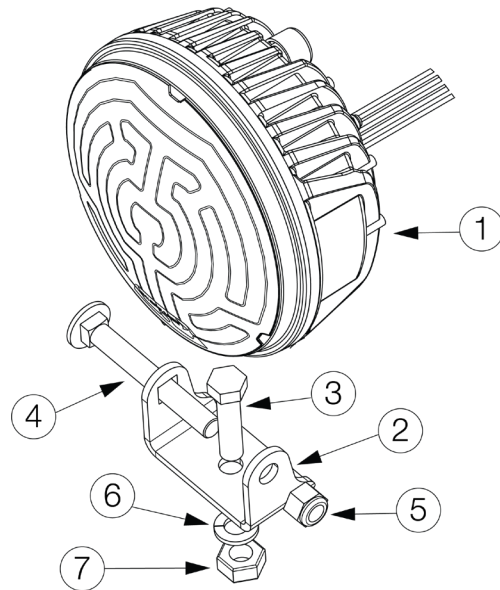

PRODUCT WARRANTY:

If you have issues with a J.W. Speaker product, please contact the authorized retailer where you purchased it.



INSTALLATION INSTRUCTIONS:

BEFORE BEGINNING: J.W. Speaker's Model 8632 Light is intended for the Industrial and Transport markets.

1. Turn off the equipment and disconnect the power supply.
2. Ensure that the mounting location is a FLAT, SOLID surface of the same (or larger) size as the bracket or light. This will prevent warping or distortion that can cause cracking or damage to the light and/or bracket.
3. Check condition of all wires, connectors, mating connectors, or gaskets. All connections should be adequately protected against moisture. Shrink tubing is recommended.
4. Carefully connect the wires or connector using the "Wire Functions" and "Voltage" information on page 1. With connectors, push firmly to ensure that it is properly mated with the lamp, creating a seal to protect against water ingress.
5. Lay and secure the wiring so that no pulling or abrasion can occur. Proper installation requires there to be a little slack near the lamp to avoid pulling on the connector (which can create a path for water ingress). Wires should be adequately secured to avoid damage.

6. When mounting the lamp follow the RH and LH stickers to properly install them on the proper side. Use the outer amber light indicator to ensure proper placement. (See example below).
7. Secure it to the mounting surface then aim the light

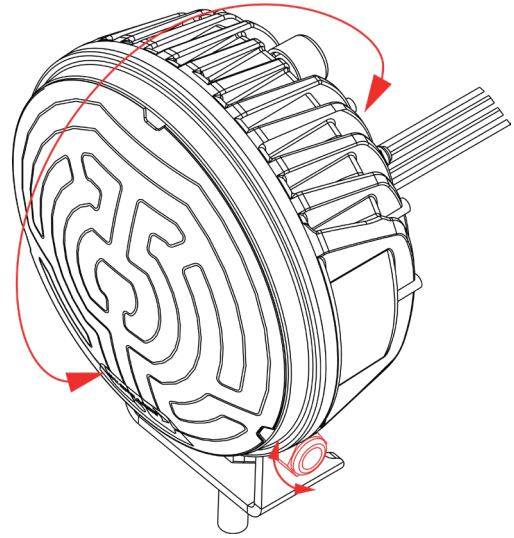

8. Periodically check the light to make sure that it is working properly and is securely attached.