

INSTALLATION INSTRUCTIONS

⚠ WARNING

To properly install this light you should have a good understanding of electrical procedures and systems. **IF YOU DO NOT, PLEASE SEEK PROFESSIONAL ASSISTANCE.**

BEFORE INSTALLATION:

Estimated Time: 90 minutes

Tools Needed: 5mm Hex Key
15mm Wrench
T20 Torx Wrench
For Wiring:
Heat Gun
Wire Stripper/Crimper

Wire Functions: Black = Ground
Red = Power

In the Box:

1. (12x) M4 Bezel Screws
2. (2x) Outer Bezels
3. (6x) Outer Lens
4. (4x) Lock Washers
5. (4x) 1/4" Bolts
6. (2x) Mounting Bolts
7. (2x) Brackets
8. (2x) Hex Nuts
9. (2x) Trail 6 Pro/Sport Lights
10. (2x) Mounting Washers
11. (2x) Quick Disconnect Harnesses

Input Voltage: 12V DC

Operating Voltage: 9-16V DC

PRE-INSTALLATION INSTRUCTIONS:

1. Read all safety notes and mounting guidelines before installing the product. Verify that all parts listed under "In the Box" are present and complete.
2. Inspect the product for damage. DO NOT install the product if there is any damage. Contact the authorized retailer where you purchased it to initiate a warranty claim if there is damage.
3. Verify that all power supply and/or charging systems comply to the specified voltage limits for the light.

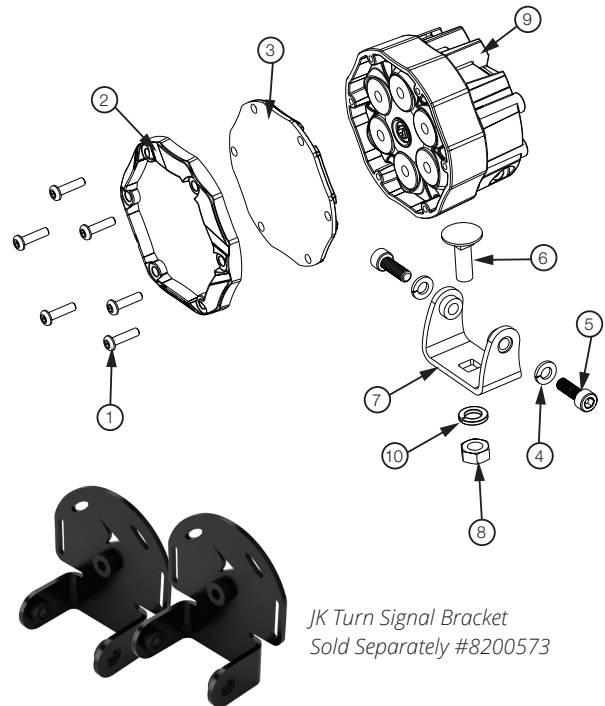

IMPORTANT NOTES:

ONLY REPLACE stock turn signal with a **TRAIL 6** if you have the **EVO J3** headlight with built-in turn signal **INSTALLED**.

The J.W. Speaker **Jeep JK Turn Signal Bracket** is needed for this install and is **SOLD SEPARATELY (Part #8200573)**.

To properly install this light you should have a good understanding of automotive electrical procedures and systems, and proficiency in the installation of lights.
IF YOU DO NOT, PLEASE SEEK PROFESSIONAL ASSISTANCE.

PRODUCT WARRANTY:

If you have issues with a J.W. Speaker product, please contact the authorized retailer where you purchased it.

J.W. SPEAKER®
Engineered. Lighting. Solutions.

INSTALLATION INSTRUCTIONS:

BEFORE BEGINNING: J.W. Speaker's EVO J3 Headlights with built-in turn signal must already be installed, and the grill of the Jeep removed.

IMPORTANT: The Trail 6 must be wired to a 10 Amp Circuit.

1. First choose between the Spot, Flood, or Wide Flood lens (#3) to install. Lay the lens flat on top of the light.

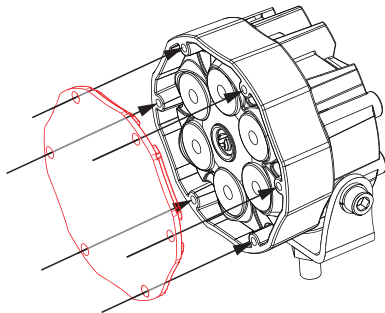

2. Place the outer bezel (#2) on the lamp over the lens. Be sure the J.W. Speaker logo on the outer bezel is oriented at the bottom of the lamp.

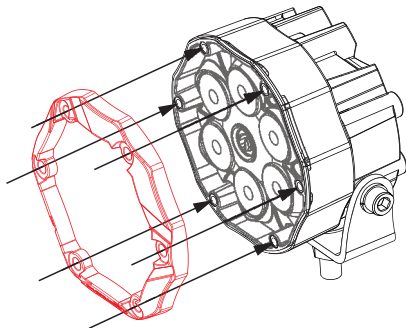

3. Take 6 of the M4 bezel screws (#1), place them in the holes of the outer bezel, and fasten the lens and bezel to the light using the T20 Torx Wrench. Repeat steps 1-3 on the other light.

NOTE: For this install remove the pre-installed bracket (#7) from each light.

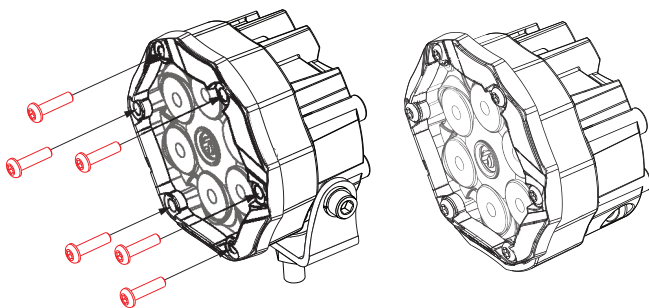

4. First remove the stock LED turn signals by depressing the black locking tabs and applying a slight downward pressure. The light will pop right out.



5. Take the Jeep JK turn signal bracket (sold separately) and line up the slots in the stock turn signal bucket. Bolt it together with provided hardware and tighten.



6. Feed the wire through first, from the front of the grill. Then line up the bracket holes and insert the 2 side bolts (#5). Tighten with a 5mm Hex Key. Reattached the grill on the Jeep.



7. Test to make sure the light is working. Now you're ready to hit the trails!



J.W. SPEAKER®
Engineered. Lighting. Solutions.