

# LED Signal Lights – Military Black Out Lights

## PRODUCT INFORMATION

<b>Description</b>	24V RH Blackout Driving Light - Bulk Qty (18 MIN)
<b>Height</b>	39.88 mm / 1.57 in
<b>Width</b>	59.94 mm / 2.36 in
<b>Depth</b>	47.24 mm / 1.86 in
<b>Shape</b>	Round
<b>Outer Lens Material</b>	Polycarbonate
<b>Outer Lens Color</b>	Clear
<b>Housing Material</b>	Nylon
<b>Housing Color</b>	Black
<b>Mounting Hardware Description</b>	(x2) #6-Screw
<b>Mounting Type</b>	Flange Mount
<b>Minimum Operating Temperature</b>	-40 °C / -40 °F
<b>Maximum Operating Temperature</b>	85 °C / 185 °F
<b>Connector or Wiring</b>	Deutsch DT04-2P
<b>Mating Connector</b>	Deutsch DT06-2S
<b>Product Weight</b>	0.08 lbs / 0.04 kgs
<b>Additional Information</b>	Light color is Cyan. Meets MIL-PRF-32212A Section 3.4 and 3.5.



Print date: 2017-07-24

© 2017 J.W. Speaker Corporation • Germantown, WI U.S.A.  
 www.jwspeaker.com • speaker@jwspeaker.com • 262.251.6660

**J.W. SPEAKER®**  
 Engineered. Lighting. Solutions.

# LED Signal Lights – Military Black Out Lights

## PRODUCT DIMENSIONS

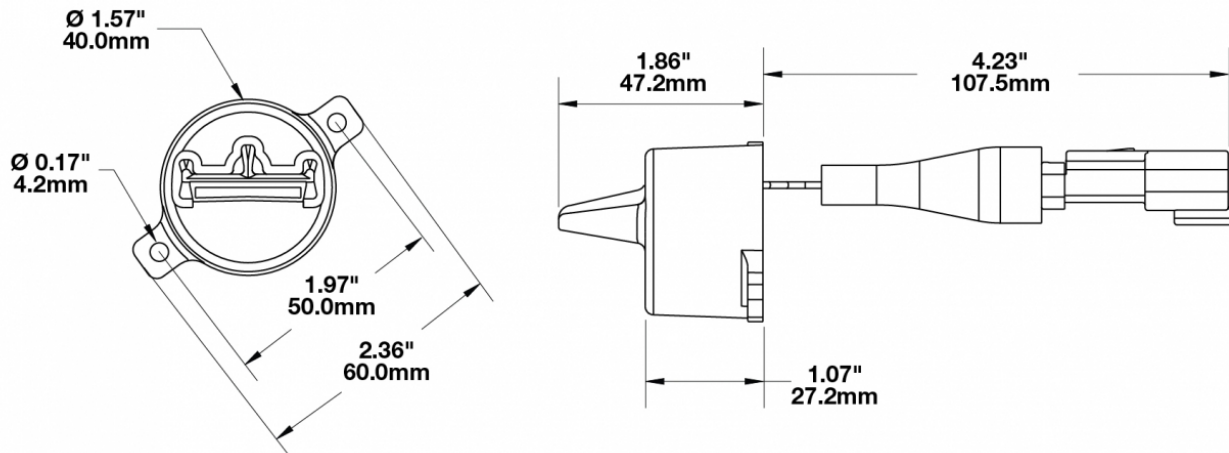

## ELECTRICAL SPECIFICATIONS

<b>Input Voltage</b>	24V DC
<b>Operating Voltage</b>	18-32V DC
<b>Black Wire</b>	Ground
<b>Red Wire</b>	Positive
<b>Current Draw</b>	0.150A @ 24V DC

## REGULATORY STANDARDS COMPLIANCE



Buy America Standards  
IEC IP67

Eco Friendly

Print date: 2017-07-24

© 2017 J.W. Speaker Corporation • Germantown, WI U.S.A.  
www.jwspeaker.com • speaker@jwspeaker.com • 262.251.6660

**J.W. SPEAKER**  
Engineered. Lighting. Solutions.

# LED Signal Lights – Military Black Out Lights

## PHOTOMETRIC SPECIFICATIONS

---

**Beam Pattern(s)** Forward Lighting - Driving

## RELATED PRODUCTS

---



**Part Number**  
**0347502**  
24V Front Blackout  
Marker Light - Bulk Qty  
(18 MIN)



**Part Number**  
**0347522**  
24V Rear Blackout  
Stop Light - Bulk Qty  
(18 MIN)



**Part Number**  
**0550312**  
24V LH Blackout  
Driving Light - Bulk Qty  
(18 MIN)