

# LED Stop, Tail, Turn & Backup Light - Model 265

## PRODUCT INFORMATION

<b>Description</b>	12-24V ECE/SAE LED Stop, Tail, Turn Signal & Backup Light
<b>Height</b>	136.65 mm / 5.38 in
<b>Width</b>	287.53 mm / 11.32 in
<b>Depth</b>	33.78 mm / 1.33 in
<b>Shape</b>	Rectangular
<b>Outer Lens Material</b>	Acrylic
<b>Outer Lens Color</b>	Amber, Clear, Red
<b>Housing Material</b>	ABS
<b>Housing Color</b>	Black
<b>Mounting Hardware Description</b>	(x2) M6-1 x 25mm Mounting Bolts
<b>Mounting Type</b>	Low Profile Mount
<b>Minimum Operating Temperature</b>	-40 °C / -40 °F
<b>Maximum Operating Temperature</b>	65 °C / 149 °F
<b>Connector or Wiring</b>	6-Pin Deutsch Socket (DT04-6P-E004); Others available
<b>Mating Connector</b>	6-Pin Deutsch Plug (DT06-6S); Others Available
<b>Product Weight</b>	1.34 lbs / 0.61 kgs
<b>Shipping Weight</b>	1.34 lbs / 0.61 kgs



Print date: 2019-01-23

© 2019 J.W. Speaker Corporation • Germantown, WI U.S.A.  
 www.jwspeaker.com • speaker@jwspeaker.com • 262.251.6660

**J.W. SPEAKER**®  
 Engineered. Lighting. Solutions.

# LED Stop, Tail, Turn & Backup Light - Model 265

## PRODUCT DIMENSIONS

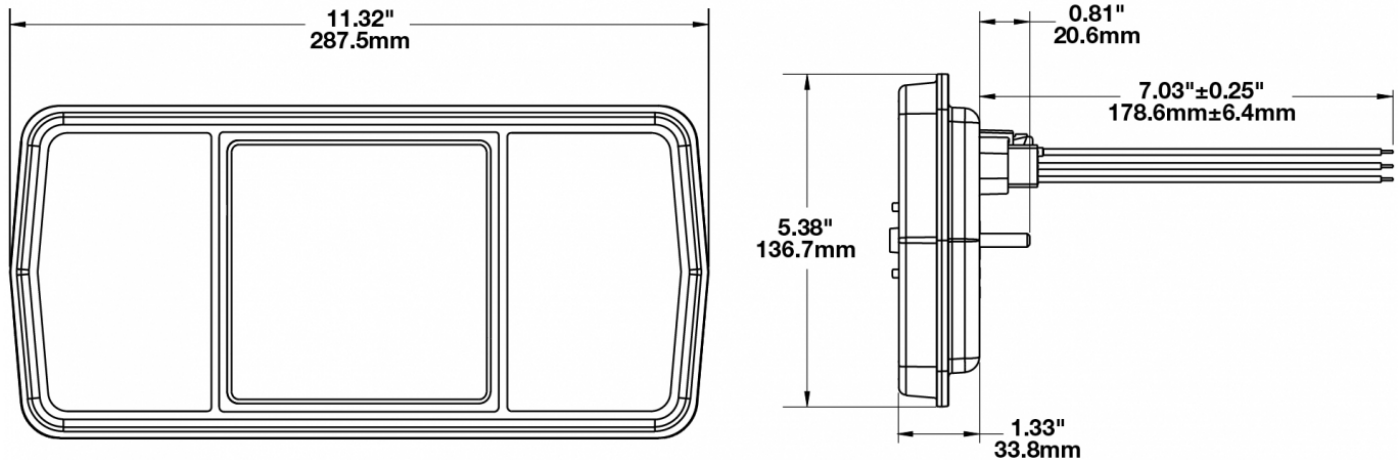

## ELECTRICAL SPECIFICATIONS

<b>Input Voltage</b>	12-24V DC
<b>White Wire</b>	Reverse
<b>Yellow Wire</b>	Turn
<b>Red Wire</b>	Stop
<b>Brown Wire</b>	Tail
<b>Black Wire</b>	Ground
<b>Current Draw</b>	0.115A @ 12V DC (Stop)
	0.075A @ 24V DC (Stop)
	0.010A @ 12V DC (Tail)
	0.010A @ 24V DC (Tail)
	0.115A @ 12V DC (Turn)
	0.080A @ 24V DC (Turn)
	0.045A @ 12V DC (Reverse)
	0.028A @ 24V DC (Reverse)

Print date: 2019-01-23

© 2019 J.W. Speaker Corporation • Germantown, WI U.S.A.  
 www.jwspeaker.com • speaker@jwspeaker.com • 262.251.6660

# LED Stop, Tail, Turn & Backup Light - Model 265

## REGULATORY STANDARDS COMPLIANCE



- |                     |                       |
|---------------------|-----------------------|
| ASABE S279          | Buy America Standards |
| ECE Reg 23          | ECE Reg 3             |
| ECE Reg 6           | ECE Reg 7             |
| Eco Friendly        | FMVSS 108 Table IX    |
| FMVSS 108 Table VII | FMVSS 108 Table VIII  |
| FMVSS 108 Table XII | FMVSS 108 Table XVI   |
| IEC IP67            | SAE J2040             |
| SAE J2261           | SAE J575              |
| SAE J585            | SAE J586              |
| SAE J588            | SAE J593              |
| SAE J594            |                       |

## PHOTOMETRIC SPECIFICATIONS

- Beam Pattern(s)**
- Signalization - Stop
  - Signalization - Tail
  - Signalization - Turn (Front)
  - Signalization - Turn (Rear)

## APPLICATIONS

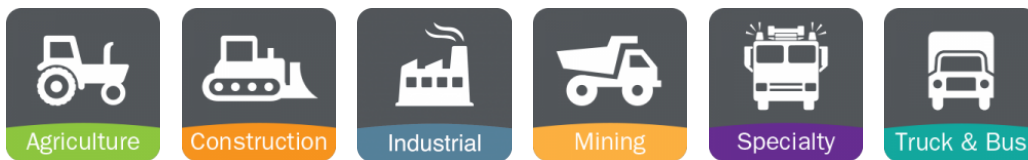

Print date: 2019-01-23

© 2019 J.W. Speaker Corporation • Germantown, WI U.S.A.  
 www.jwspeaker.com • speaker@jwspeaker.com • 262.251.6660