

LED Safety Lights and Warning Lights - Model 527

PRODUCT INFORMATION

| | |
|--------------------------------------|---------------------------------------|
| Description | 12-24V LED Amber & Green Signal Light |
| Height | 123.70 mm / 4.87 in |
| Width | 258.57 mm / 10.18 in |
| Depth | 102.11 mm / 4.02 in |
| Shape | Rectangular |
| Outer Lens Material | Acrylic |
| Outer Lens Color | Diffused White |
| Housing Material | Xenoy |
| Housing Color | Black |
| Bezel Color | Black |
| Mounting Hardware Description | (x2) M8-1.28 Mounting Bolt |
| Mounting Type | Universal Pedestal Mount |
| Minimum Operating Temperature | -40 °C / -40 °F |
| Maximum Operating Temperature | 65 °C / 149 °F |
| Connector or Wiring | ICONN IMATE 23 3-POS, MALE |
| Mating Connector | ICONN IMATE 23 3-POS, FEMALE |



PRODUCT DIMENSIONS

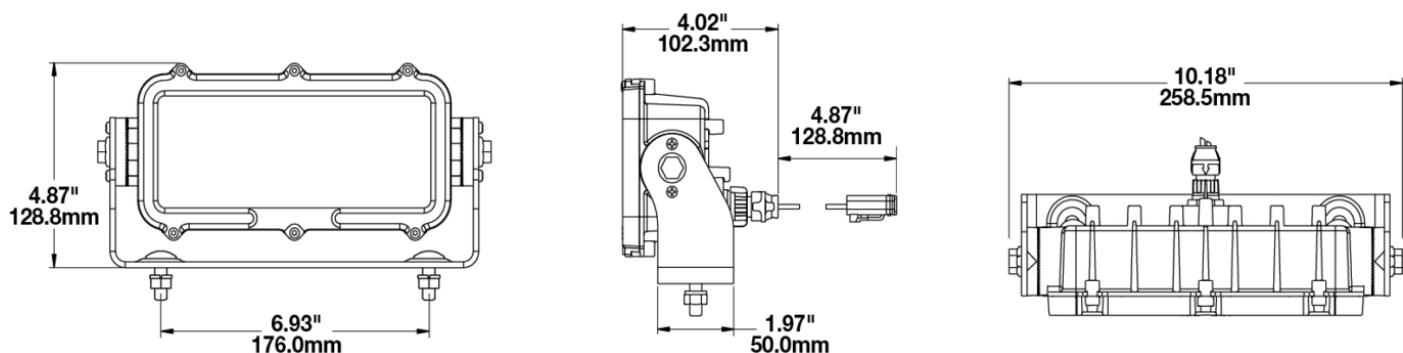

Print date: 2024-04-25

© 2024 J.W. Speaker Corporation • Germantown, WI U.S.A.
www.jwspeaker.com • speaker@jwspeaker.com • 262.251.6660

J.W. SPEAKER®
 Engineered. Lighting. Solutions.

LED Safety Lights and Warning Lights - Model 527

ELECTRICAL SPECIFICATIONS

| | |
|-----------------------------------|--|
| Input Voltage | 12-24V DC |
| Operating Voltage | 10-32V DC |
| Transient Spike Protection | 150V Peak @ 1 HZ-100 Pul |
| Black Wire | Ground |
| Red Wire | Amber |
| Green Wire | Green |
| Current Draw | 1.2A @ 12V DC (Amber) 1.2A @ 12V DC (Green) 0.7A @ 24V DC (Amber) 0.7A @ 24V DC (Green) |

REGULATORY STANDARDS COMPLIANCE



IEC IP69K

APPLICATIONS



Print date: 2024-04-25

© 2024 J.W. Speaker Corporation • Germantown, WI U.S.A.
www.jwspeaker.com • speaker@jwspeaker.com • 262.251.6660

J.W. SPEAKER®
Engineered. Lighting. Solutions.

LED Safety Lights and Warning Lights - Model 527

PRODUCT WARNINGS

For California residents:

⚠ **WARNING:** Cancer and reproductive harm - www.P65Warnings.ca.gov.

⚠ **AVERTISSEMENT:** Cancer et effet nocif sur la reproduction - www.P65Warnings.ca.gov.

ACCESSORIES



Part Number

8200151

Rock Guard Kit for
Model 527

RELATED PRODUCTS



Part Number

0549271

12-24V LED Red Zone
Light



Part Number

0551261

12-24V LED White
Zone Light



Part Number

0551271

12-24V LED Green
Zone Light



Part Number

0551281

12-24V LED Amber
Zone Light



Part Number

0647011

12-24V LED Red &
Green Signal Light

Print date: 2024-04-25

© 2024 J.W. Speaker Corporation • Germantown, WI U.S.A.
www.jwspeaker.com • speaker@jwspeaker.com • 262.251.6660

J.W. SPEAKER®
Engineered. Lighting. Solutions.