

LED Headlight – Model 8632 Evolution

PRODUCT INFORMATION

| | |
|--------------------------------------|--|
| Description | 12-24V ECE LED LHT High & Low Beam Headlights with Turn Signal, FP & DRL - 2 Light Kit |
| Height | 173.00 mm / 6.81 in |
| Width | 144.00 mm / 5.67 in |
| Depth | 86.00 mm / 3.39 in |
| Shape | Round |
| Outer Lens Material | Polycarbonate |
| Outer Lens Color | Clear |
| Housing Material | Aluminum |
| Housing Color | Black |
| Mounting Type | Pedestal |
| Minimum Operating Temperature | -34 °C / -29.2 °F |
| Maximum Operating Temperature | 49 °C / 120.2 °F |
| Connector or Wiring | Integral Connector in Housing simulating Delphi 12124107, |
| Mating Connector | Delphi 12052848 |
| Product Weight | 4.80 lbs / 2.18 kgs |
| Shipping Weight | 5.40 lbs / 2.45 kgs |



Print date: 2025-07-16

© 2025 J.W. Speaker Corporation • Germantown, WI U.S.A.
www.jwspeaker.com • speaker@jwspeaker.com • 262.251.6660

J.W. SPEAKER®
Engineered. Lighting. Solutions.

LED Headlight – Model 8632 Evolution

PRODUCT DIMENSIONS

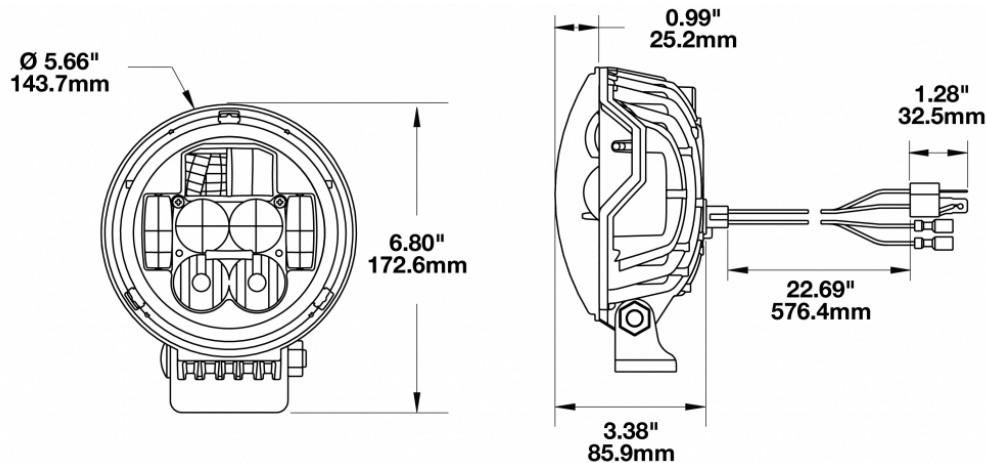

ELECTRICAL SPECIFICATIONS

| | |
|-----------------------------------|---|
| Input Voltage | 12-24 V |
| Operating Voltage | 10-32 V |
| Transient Spike Protection | 150V Peak @ 1 HZ-100 Pul |
| White Wire | High Beam |
| Yellow Wire | Low Beam |
| Black Wire | Ground |
| Red Wire | Front Position |
| Purple Wire | DRL |
| Orange/white Wire | Front Turn |
| Current Draw | 3.67A @ 12V (High Beam) 1.83A @ 24V (High Beam) 2.5A @ 12V (Low Beam) 1.25A @ 24V (Low Beam) .67A @ 12V (DRL) .34A @ 24V (DRL) .83A @ 12V (Front Turn) .42A @ 24V (Front Turn) .08A @ 12V (Front Position) .042A @ 24V (Front Position) .08A @ 12V (Side Marker) .042A @ 24V (Side Marker) |

Print date: 2025-07-16

© 2025 J.W. Speaker Corporation • Germantown, WI U.S.A.
 www.jwspeaker.com • speaker@jwspeaker.com • 262.251.6660

LED Headlight – Model 8632 Evolution

REGULATORY STANDARDS COMPLIANCE



| | |
|-----------------------|--------------|
| Buy America Standards | ECE Reg 112 |
| ECE Reg 6 | ECE Reg 7 |
| ECE Reg 87 | Eco Friendly |
| IEC IP67 | |

PHOTOMETRIC SPECIFICATIONS

| | |
|--------------------------------------|---|
| Raw Lumen Output | 2,925 (High Beam); 2,025 (Low Beam) |
| Effective Lumen Output | 1,000 (High Beam); 630 (Low Beam) |
| Nominal LED Color Temperature | 5000 K |
| Beam Pattern(s) | Forward Lighting - Daytime Running Light Forward Lighting - High Beam (DOT/ECE) Forward Lighting - Low Beam (ECE Left Hand) Signalization - Front Position Signalization - Marker Signalization - Turn (Front) |

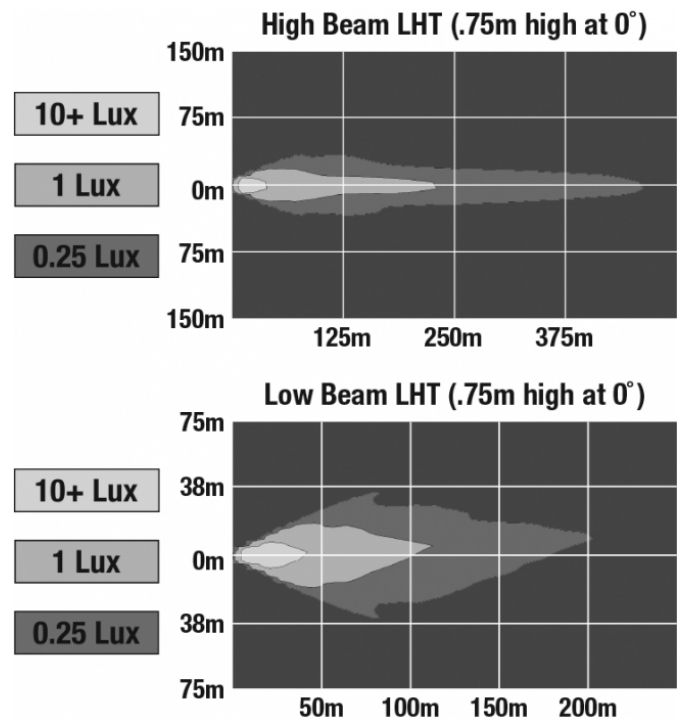

Print date: 2025-07-16

© 2025 J.W. Speaker Corporation • Germantown, WI U.S.A.
www.jwspeaker.com • speaker@jwspeaker.com • 262.251.6660

J.W. SPEAKER®
Engineered. Lighting. Solutions.

LED Headlight – Model 8632 Evolution

APPLICATIONS



PRODUCT WARNINGS

For California residents:

⚠ **WARNING:** Cancer and reproductive harm - www.P65Warnings.ca.gov.

⚠ **AVERTISSEMENT:** Cancer et effet nocif sur la reproduction - www.P65Warnings.ca.gov.

RELATED PRODUCTS



Part Number
0551561

12-24V DOT/ECE LED
RHT Right Hand High
& Low Beam Headlight
with Turn Signal, FP &
DRL



Part Number
0551571

12-24V DOT/ECE LED
RHT Left Hand High &
Low Beam Headlight
with Turn Signal, FP &
DRL



Part Number
0551983

12-24V DOT/ECE LED
RHT High & Low Beam
Headlights with Turn
Signal, FP & DRL - 2
Light Kit



Part Number
0551991

12-24V ECE LED LHT
Right Hand High &
Low Beam Headlight
with Turn Signal, FP &
DRL



Part Number
0552001

12-24V ECE LED LHT
Left Hand High & Low
Beam Headlight with
Turn Signal, FP & DRL

Print date: 2025-07-16

© 2025 J.W. Speaker Corporation • Germantown, WI U.S.A.
www.jwspeaker.com • speaker@jwspeaker.com • 262.251.6660

J.W. SPEAKER®
Engineered. Lighting. Solutions.