

Trailer Hitch Wire Harness for Model 4416

PRODUCT INFORMATION

Description	Trailer Hitch Wire Harness for Model 4416
Connector or Wiring	2-pin trailer harness to female 12V power port
Product Weight	0.20 lbs / 0.09 kgs
Shipping Weight	2.29 lbs / 1.04 kgs



Print date: 2019-02-16

© 2019 J.W. Speaker Corporation • Germantown, WI U.S.A.
www.jwspeaker.com • speaker@jwspeaker.com • 262.251.6660

Trailer Hitch Wire Harness for Model 4416

PRODUCT DIMENSIONS

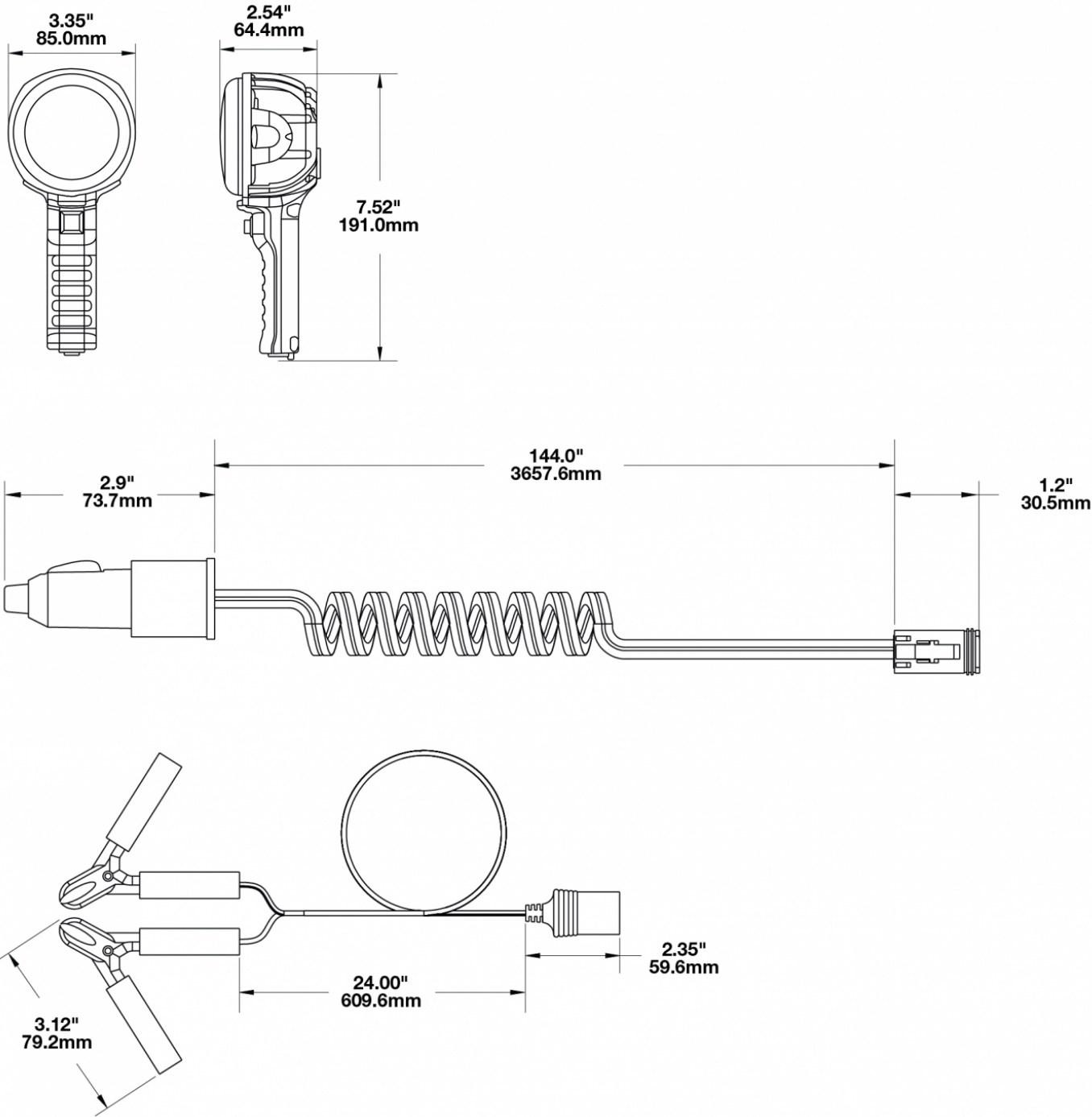

Print date: 2019-02-16

© 2019 J.W. Speaker Corporation • Germantown, WI U.S.A.
www.jwspeaker.com • speaker@jwspeaker.com • 262.251.6660



Trailer Hitch Wire Harness for Model 4416

REGULATORY STANDARDS COMPLIANCE



Buy America Standards



Eco Friendly

SUITS THESE PRODUCTS



**3.5" Round Portable
LED Hand Held Lamp
- Black and
Camouflage**

LED Handheld Work
Light – Model 4416

Print date: 2019-02-16

© 2019 J.W. Speaker Corporation • Germantown, WI U.S.A.
www.jwspeaker.com • speaker@jwspeaker.com • 262.251.6660