

# LED Signal Lights – Military Black Out Lights

## PRODUCT INFORMATION

|                                      |  |
|--------------------------------------|--|
| <b>Description</b>                   | 24V LH Blackout Driving Light - Bulk Qty (18 MIN)              |
| <b>Height</b>                        | 39.88 mm / 1.57 in   |
| <b>Width</b>                         | 59.94 mm / 2.36 in   |
| <b>Depth</b>                         | 47.24 mm / 1.86 in   |
| <b>Shape</b>                         | Round  |
| <b>Outer Lens Material</b>           | Polycarbonate  |
| <b>Outer Lens Color</b>              | Clear  |
| <b>Housing Material</b>              | Nylon  |
| <b>Housing Color</b>                 | Black  |
| <b>Mounting Hardware Description</b> | (x2) #6-Screw  |
| <b>Mounting Type</b>                 | Flange Mount   |
| <b>Minimum Operating Temperature</b> | -40 °C / -40 °F  |
| <b>Maximum Operating Temperature</b> | 85 °C / 185 °F   |
| <b>Connector or Wiring</b>           | Deutsch DT04-2P  |
| <b>Mating Connector</b>              | Deutsch DT06-2S  |
| <b>Product Weight</b>                | 0.08 lbs / 0.04 kgs  |
| <b>Additional Information</b>        | Light color is Cyan. Meets MIL-PRF-32212A Section 3.4 and 3.5. |



Print date: 2018-06-23

© 2018 J.W. Speaker Corporation • Germantown, WI U.S.A.  
 www.jwspeaker.com • speaker@jwspeaker.com • 262.251.6660

**J.W. SPEAKER®**  
 Engineered. Lighting. Solutions.

# LED Signal Lights – Military Black Out Lights

## PRODUCT DIMENSIONS

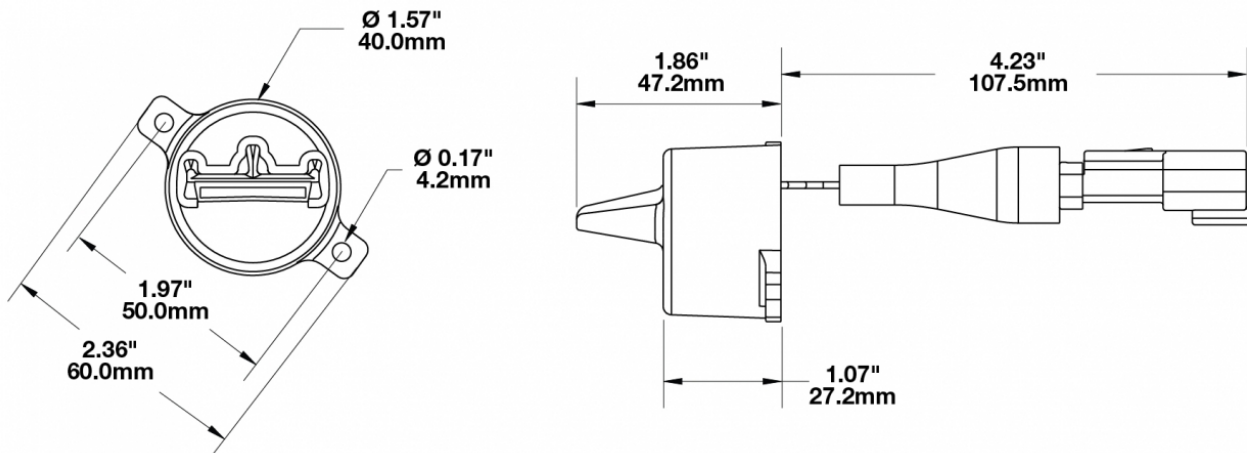

## ELECTRICAL SPECIFICATIONS

|                          |                 |
|--------------------------|-----------------|
| <b>Input Voltage</b>     | 24V DC          |
| <b>Operating Voltage</b> | 18-32V DC       |
| <b>Black Wire</b>        | Ground          |
| <b>Red Wire</b>          | Power           |
| <b>Current Draw</b>      | 0.150A @ 24V DC |

## REGULATORY STANDARDS COMPLIANCE



Buy America Standards  
IEC IP67

Eco Friendly

Print date: 2018-06-23

© 2018 J.W. Speaker Corporation • Germantown, WI U.S.A.  
www.jwspeaker.com • speaker@jwspeaker.com • 262.251.6660

**J.W. SPEAKER**  
Engineered. Lighting. Solutions.

# LED Signal Lights – Military Black Out Lights

## PHOTOMETRIC SPECIFICATIONS

---

**Beam Pattern(s)** Forward Lighting - Driving

## RELATED PRODUCTS

---



**Part Number**  
**0347502**  
24V Front Blackout  
Marker Light - Bulk Qty  
(18 MIN)



**Part Number**  
**0347512**  
24V Rear Blackout Tail  
Light - Bulk Qty (18  
MIN)



**Part Number**  
**0347522**  
24V Rear Blackout  
Stop Light - Bulk Qty  
(18 MIN)



**Part Number**  
**0550732**  
24V RH Blackout  
Driving Light - Bulk Qty  
(18 MIN)

---

**Print date: 2018-06-23**

© 2018 J.W. Speaker Corporation • Germantown, WI U.S.A.  
www.jwspeaker.com • speaker@jwspeaker.com • 262.251.6660