

LED Stop, Tail, Turn & Backup Light - Model 265

PRODUCT INFORMATION

Description	12-24V ECE/SAE LED Stop, Tail, Turn Signal & Backup Light
Height	136.65 mm / 5.38 in
Width	287.53 mm / 11.32 in
Depth	33.78 mm / 1.33 in
Shape	Rectangular
Outer Lens Material	Acrylic
Outer Lens Color	Amber, Clear, Red
Housing Material	ABS
Housing Color	Black
Mounting Hardware Description	(x2) M6-1 x 25mm Mounting Bolts
Mounting Type	Low Profile Mount
Minimum Operating Temperature	-40 °C / -40 °F
Maximum Operating Temperature	65 °C / 149 °F
Connector or Wiring	6-Pin Deutsch Socket (DT04-6P-E004); Others available
Mating Connector	6-Pin Deutsch Plug (DT06-6S); Others Available
Product Weight	1.34 lbs / 0.61 kgs
Shipping Weight	1.34 lbs / 0.61 kgs



Print date: 2018-04-23

© 2018 J.W. Speaker Corporation • Germantown, WI U.S.A.
www.jwspeaker.com • speaker@jwspeaker.com • 262.251.6660

J.W. SPEAKER 
 Engineered. Lighting. Solutions.

LED Stop, Tail, Turn & Backup Light - Model 265

PRODUCT DIMENSIONS

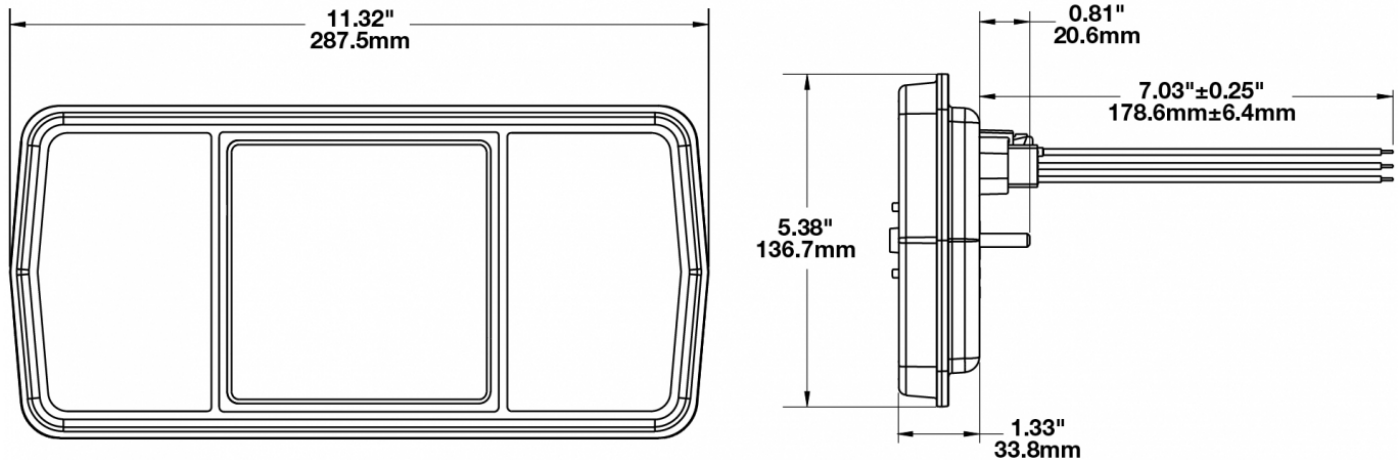

ELECTRICAL SPECIFICATIONS

Input Voltage	12-24V DC
White Wire	Reverse
Yellow Wire	Turn
Red Wire	Stop
Brown Wire	Tail
Black Wire	Ground
Current Draw	0.115A @ 12V DC (Stop)
	0.75A @ 24V DC (Stop)
	0.010A @ 12V DC (Tail)
	0.010A @ 24V DC (Tail)
	0.115A @ 12V DC (Turn)
	0.80A @ 24V DC (Turn)
	0.045A @ 12V DC (Reverse)
	0.028A @ 24V DC (Reverse)

Print date: 2018-04-23

© 2018 J.W. Speaker Corporation • Germantown, WI U.S.A.
 www.jwspeaker.com • speaker@jwspeaker.com • 262.251.6660

LED Stop, Tail, Turn & Backup Light - Model 265

REGULATORY STANDARDS COMPLIANCE



- | | |
|---------------------|-----------------------|
| ASABE S279 | Buy America Standards |
| ECE Reg 23 | ECE Reg 3 |
| ECE Reg 6 | ECE Reg 7 |
| Eco Friendly | FMVSS 108 Table IX |
| FMVSS 108 Table VII | FMVSS 108 Table VIII |
| FMVSS 108 Table XII | FMVSS 108 Table XVI |
| IEC IP67 | SAE J2040 |
| SAE J2261 | SAE J575 |
| SAE J585 | SAE J586 |
| SAE J588 | SAE J593 |
| SAE J594 | |

PHOTOMETRIC SPECIFICATIONS

- Beam Pattern(s)**
- Signalization - Stop
 - Signalization - Tail
 - Signalization - Turn (Front)
 - Signalization - Turn (Rear)

APPLICATIONS



Print date: 2018-04-23

© 2018 J.W. Speaker Corporation • Germantown, WI U.S.A.
www.jwspeaker.com • speaker@jwspeaker.com • 262.251.6660

